

616AP & 617AP

Package Contains:

1. HydroPump
2. Suction tubing
3. Hardware kit: 2 long screws and anchors; 2 short screws; 22cc stroke adjuster; 15cc stroke adjuster; flow restrictor
4. Mounting plate
5. Discharge tube
6. Instruction sheet

Installation and Operation:

For model 616AP (with directional spout), screw the spout into the larger elbow on the pump.

1. Remove the skirt by unscrewing the nut holding the plunger. **Caution: the plunger is spring-loaded and will come out forcefully when this nut is removed.** Be careful not to get dirt on the red O-ring seal on the plunger, or the pump may not seal correctly, resulting in leaking.
2. The HydroPump should be mounted at a convenient height, ideally so that inlet and discharge tubing will be 2 m or less in length. Note: The arrows on the pump show the direction product will move through the pump. Mount the unit so the discharge elbow will be in the correct location as desired.
 - a. Select a reasonably flat area on which to mount the Pump. Concentrate should be positioned below the end of the discharge tube. (Never mount concentrate higher than the dispensing unit).
 - b. Use a 7mm diameter bit to drill holes centered as indicated on the template on the back of these instructions. (You may wish to copy the template instead of cutting these instructions.) Install anchors provided into the holes, then use the long screws provided to attach the pump to the surface selected.
 - c. If you are replacing an old pump, the mounting plate included may be used so you do not have to drill new holes for the anchors. Use the screws from the old pump to attach the mounting plate, then attach the new pump with the short screws provided.
3. Replace the skirt and attach the plunger to the pump with the nut. The nut should be hand tightened. Note: Included with the pump are two stroke adjusters. These can be used to change the amount the pump dispenses with each push. With no adjuster, the pump will dispense 30cc. The short adjuster reduces this to 22cc, while the longer one reduces the dispensed amount to 15cc per push. These adjusters are placed on the post on the inside of the plunger. Attach the adjuster, if desired, to the plunger before re-assembling the plunger to the pump.
4. Install the inlet tubing:
 - a. From the tubing provided, cut a length which reaches from the bottom of the liquid container to the supply inlet. Make sure that the suction tube is at the bottom of the liquid container in order to fully empty the container, and that the liquid container is vented.
 - b. Slide tubing onto the inlet elbow and swivel the inlet elbow as required.
 - c. Elbows and tees may be used in the installation of the pump, but bear in mind that they introduce extra resistance to the flow of the liquid being dispensed.

Note: Included with the pump is a flow restrictor. This will delay the recovery of the plunger after it is pushed to prevent multiple strokes, if required. It will also prevent any residual discharge of product which may occur at the end of the stroke. If required, press the restrictor into the inlet elbow before attaching the inlet tubing.
5. The remaining length of tubing may be used as a discharge tube (not required on model 616GB which includes the spout). Slide tubing onto the discharge elbow and swivel discharge elbow to direct tubing as required.
6. Press the HydroPump pusher firmly several times to prime. Product will move through the pump in the direction shown by the arrows on the pump.
7. Once the pump is primed, each push will dispense 30cc of concentrate (or 22cc or 15cc if stroke adjuster is used). Dispense the concentrate into an empty container by pushing the required number of times, then fill the container with water to the desired level. When correctly installed, the Pump will not lose its prime overnight.

Parts Diagram/List:

KEY NO.	PART NO.	DESCRIPTION
1	10083207	Skirt
2	10083222	Mounting plate
3	10083260	Spout (model 616AP only)

Not shown:
 10089101 Suction tubing, 2 m, model 616AP
 10089102 Suction tubing, 2.4 m model 617AP

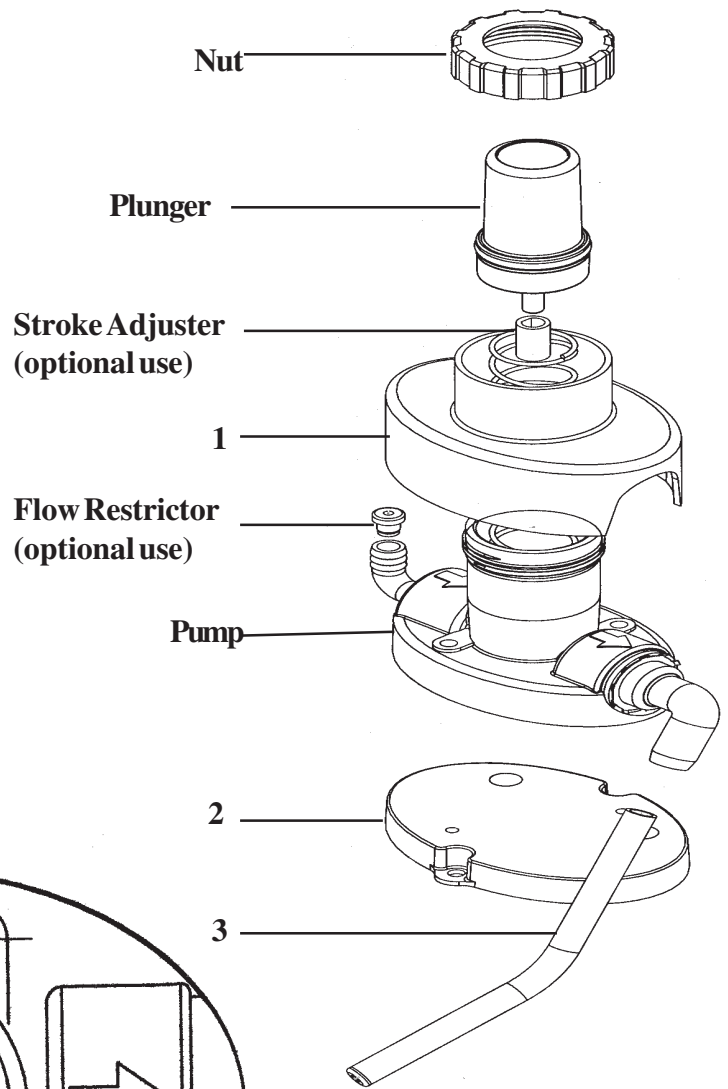

Template:

